

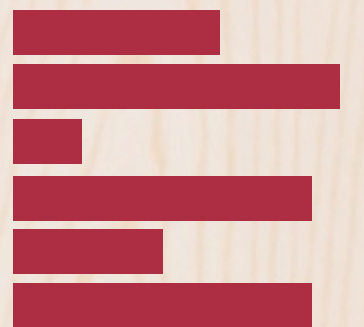

GLASIR FLOOR PLAN

GLASIR IS THE LARGEST EDUCATIONAL INSTITUTION IN THE FAROE ISLANDS. WITH MORE THAN 1.500 STUDENTS AND 250 STAFF, GLASIR OFFERS EDUCATIONS SPANNING FROM 6TH FORM, TO VOCATIONAL AND HIGHER EDUCATION WITHIN A VARIETY OF DIFFERENT FIELDS

THIS LEAFLET GIVES YOU AN OVERVIEW OVER THE SIX FLOORS OF GLASIR. THE BUILDING, DESIGNED BY THE INTERNATIONALLY ACCLAIMED ARCHITECTURAL STUDIO BIG, LED BY DANISH ARCHITECT BJARKE INGELS, IS SOME 19.500M²



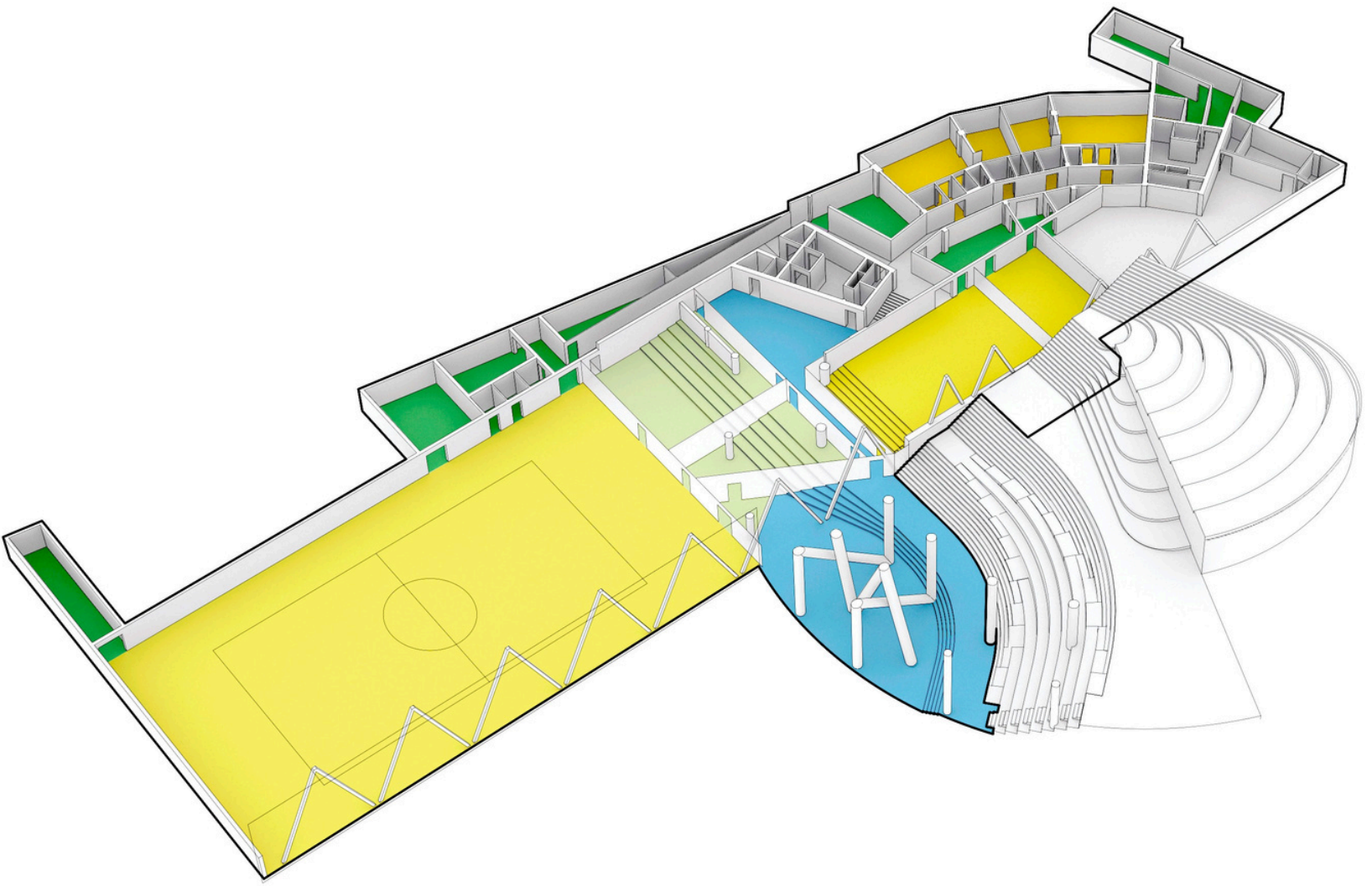

1ST FLOOR

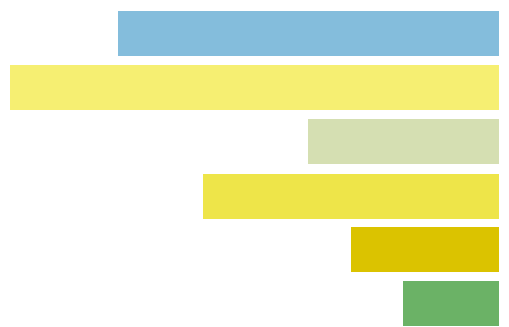

- COMMON AREA
- PHYSICAL EDUCATION, SPORTS
- LECTURE HALL
- MULTIFUNCTIONAL HALL
- LOCKER ROOMS
- STORAGE/TECHNOLOGY

2ND FLOOR

COMMON AREA
WORKSHOP, METALWORK
WORKSHOP, CARPRENTRY
LIBRARY CLASSROOMS

TECHNOLOGY/STORAGE

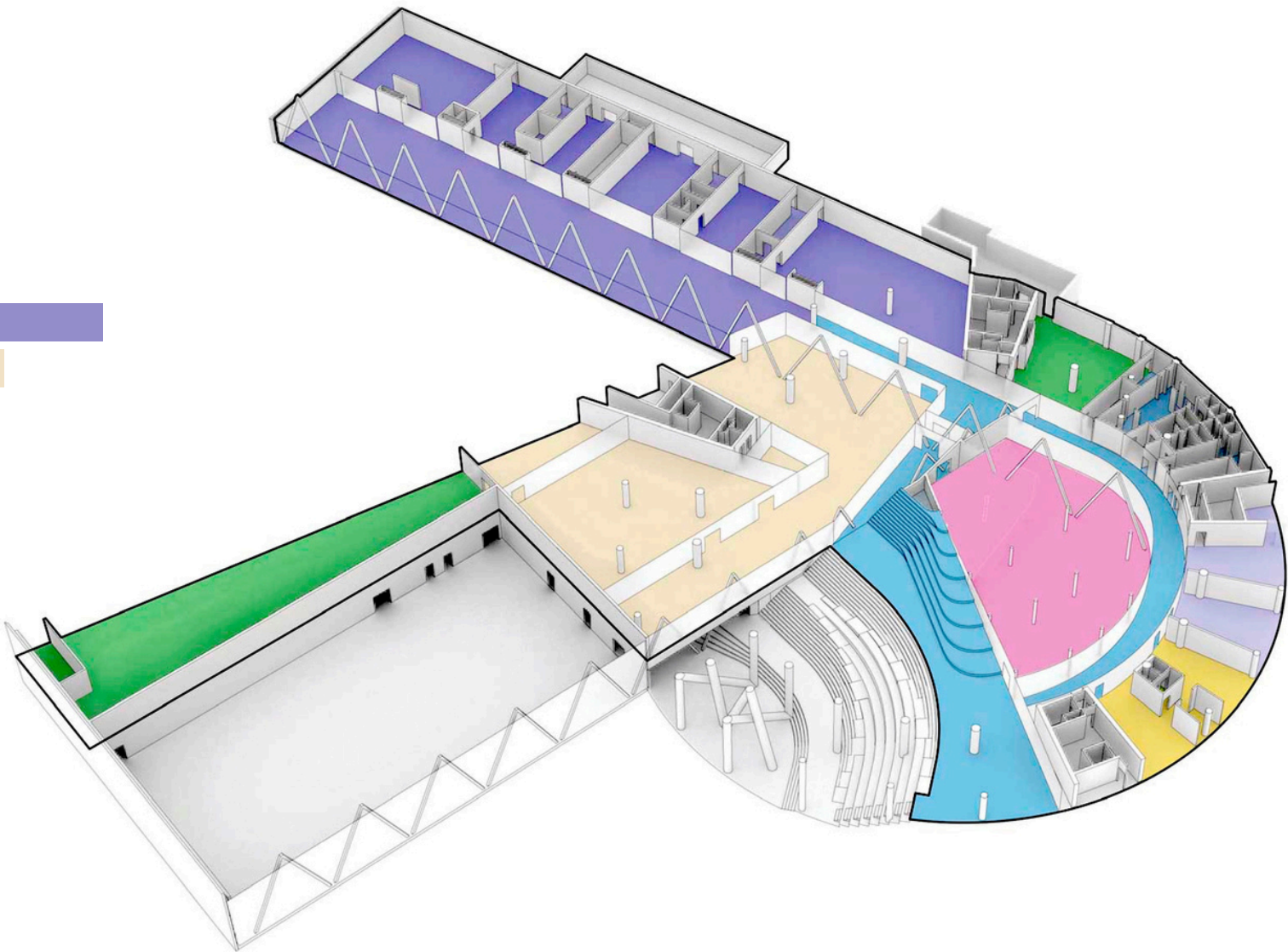
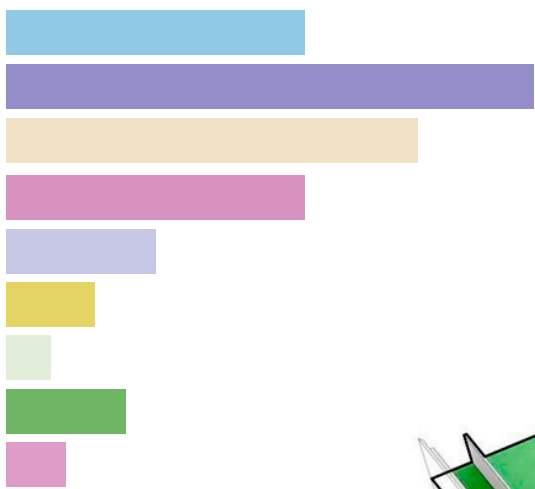

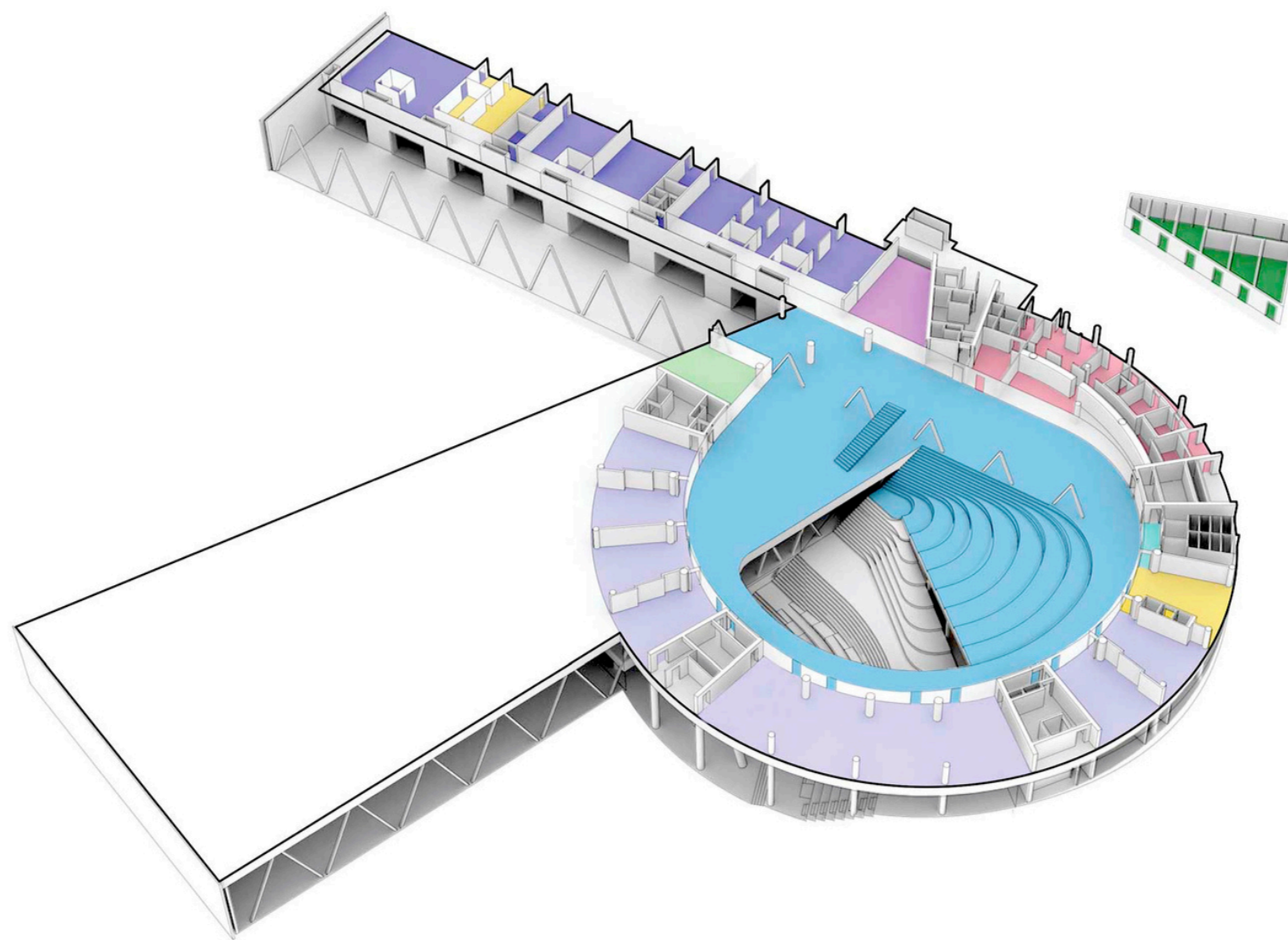

3RD FLOOR

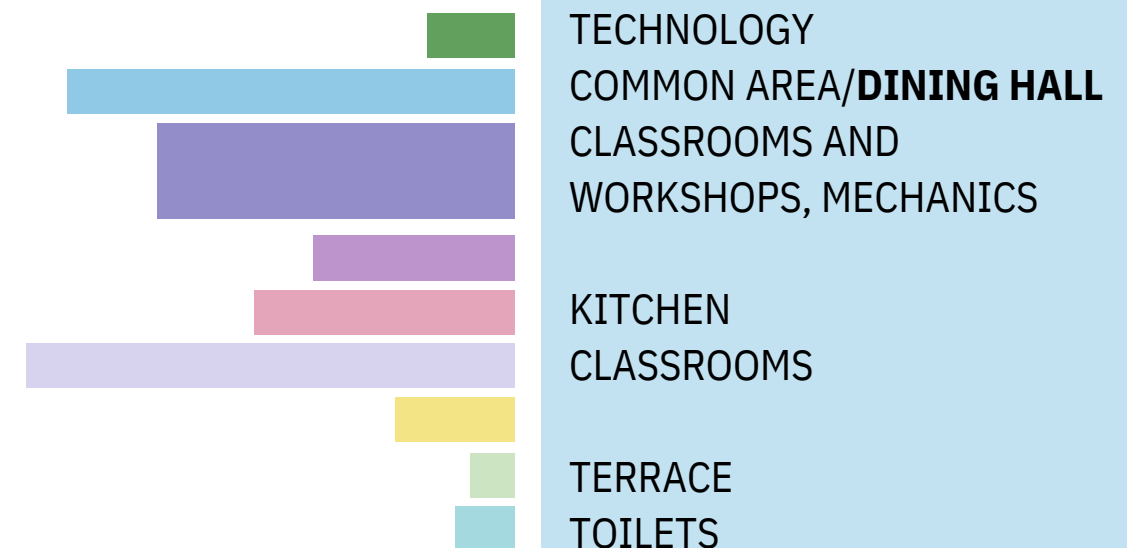

4TH FLOOR

COMMON AREA
CLASSROOMS AND WORKSHOPS, **MUSIC**
CLASSROOMS AND WORKSHOPS, **ARTS**,
MEDIA STUDIES, **PHOTOGRAPHY**
ADMINISTRATION, OFFICES, RECEPTION
STAFF ROOM
TEACHER'S FACILITIES
MAIN ENTRANCE/TERRACE
CLASSROOMS
TOILETS

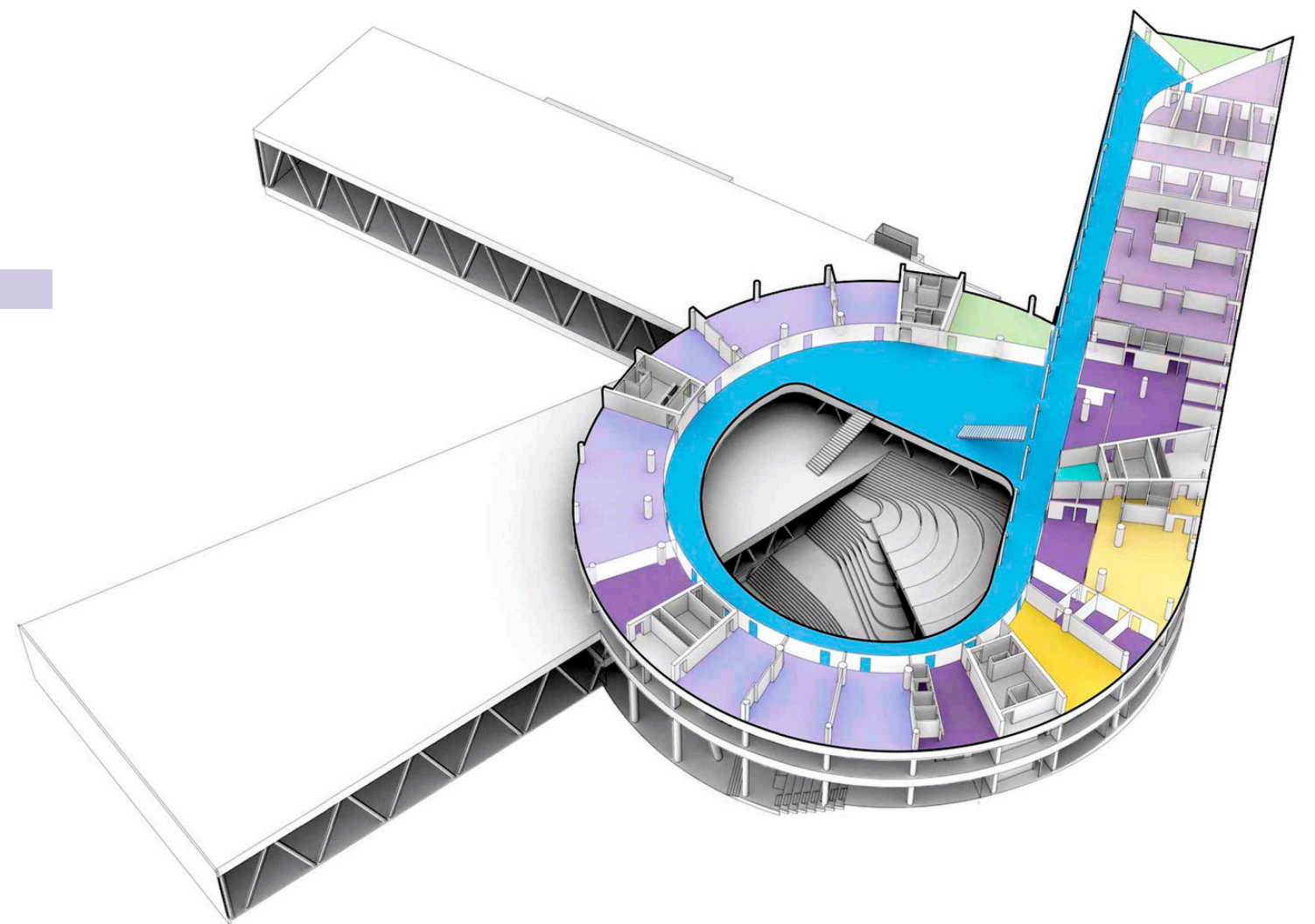
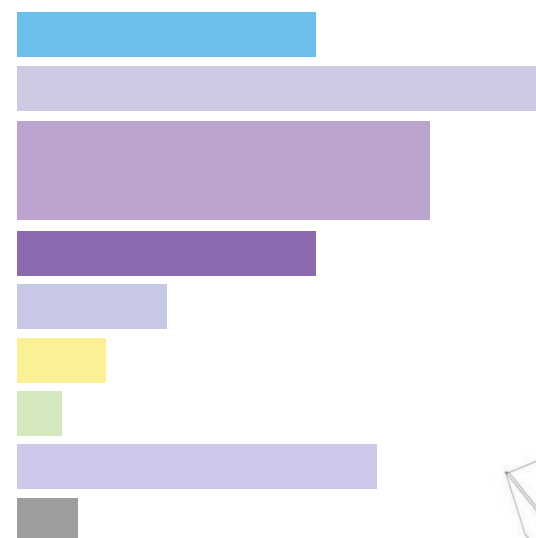

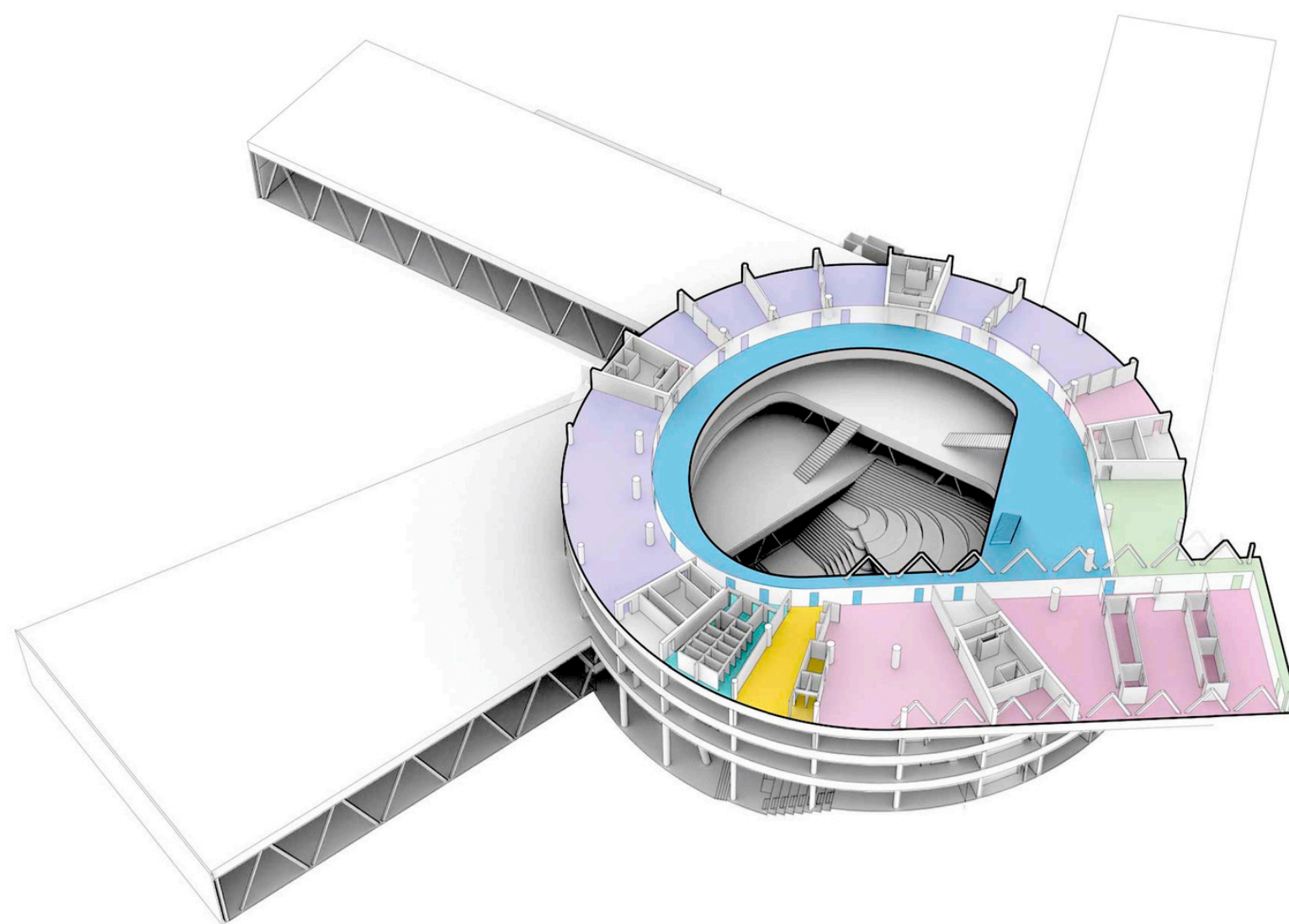

5TH FLOOR

- COMMON AREA **HAIRDRESSING**
- CLOTHING DESIGN AND **TAILORING**
- TEXTILE** CRAFT AND DESIGN
- TOILETS
- CLASSROOMS
- TERRACE

6TH FLOOR

- COMMON AREA
- CLASSROOMS
- SCIENCE LAB**
- TEACHER'S LOUNGE
- CLASSROOM/LABORATORY
- TERRACE

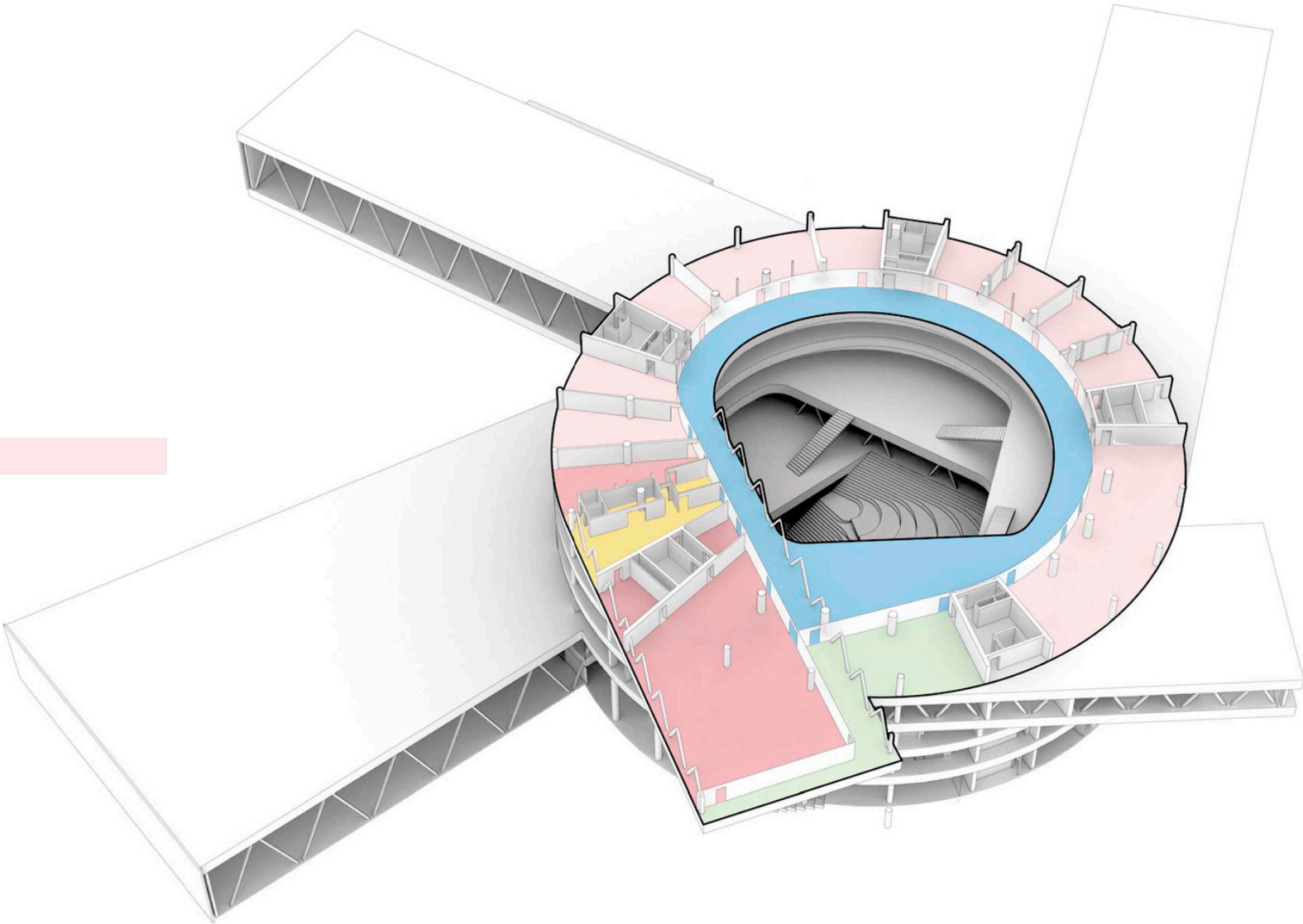



GLASIR